

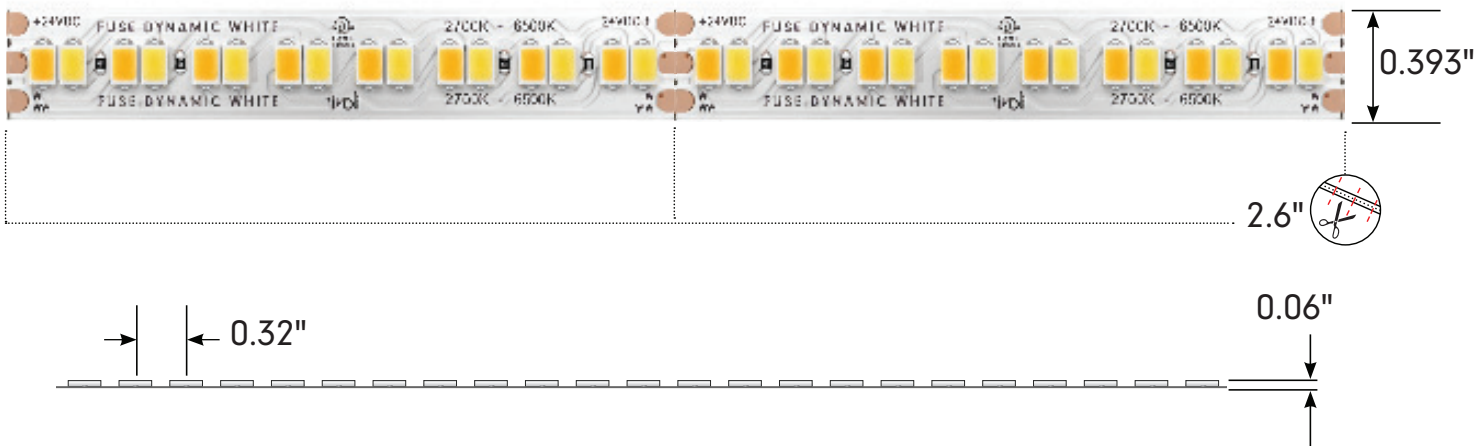

Project: _____ TYPE: _____

- Adjust color from two factory range options: 19K-35K, and 27K-65K
- Low bin tolerance with a 2 Step McAdam Elipse standard
- High efficacy value
- Includes Tivoli's eXo shield coating
- Factory soldered lead wire
- Standard IP54 damp rated and IP67 wet location available
- Multiple mounting channel options
- Low lead times
- 5 Year warranty

Dimensions



Order Guide

PRODUCT CODE	INSTALL	TYPE	LED COLOR	*MAX ROLL	VOLTAGE
TPLFS	I	DW	01		24
TPLFS = TivoTape Fuse	I = Indoor	DW = Dynamic White	01 = 1900K - 3500K 02 = 2700K - 6500K	*MR = MAX RUN	24 = 24V DC

* Optional - Leave blank if not needed

Note: A layout/drawing must accompany each order showing run length and location

Note: Runs with LEAD-C are rounded **up** to next cut interval (unless otherwise specified)

Note: Runs with LEAD-D are rounded **down** to next cur interval (unless otherwise specified)

Specification

1900K - 3500K			
Kelvin Temperature	1900K	3500K	All On (DMX only)
Lumens/ft	284.3	404.3	686.7
Efficacy (Lm/W)	88.84	130.4	105.64
CRI	95.3	97.6	93.6
Measured Power W/ft	3.2	3.1	6.5
Listed Power W/ft.	3.50	3.50	7.0
Max Run	25'	25'	12'

2700K - 6500K			
Kelvin Temperature	2700K	6500K	All On (DMX only)
Lumens/ft	409.45	440.25	840.85
Efficacy (Lm/W)	120.78	127.97	123.11
CRI	92.2	94.5	96.9
Measured Power W/ft	3.39	3.44	6.83
Listed Power W/ft.	3.50	3.50	7.0
Max Run	25'	25'	12'

Electrical	
Input Voltage	24V
Dimming/Control	0-10V/DMX
Physical	
LED Package	2835
LEDs/m	240
Adhesive	3M VHB Tape
Copper Trace	3 Ounce
Dimensions	0.393" (10mm)
Cut Increments	2.6"
Operating Temperature	-40°F (-40°C) ~ +140°F (+60°C)
Certification and Testing	
Certification	UL Listed, CE
Lumen Maintenance (L70)	60,000 hrs
Binning Tolerance	2 Step MacAdam Elipse
Environment	IP54 Damp Location, Conformal eXo Shield
Warranty	5 years

Power Leads and Jumpers (Installed by Tivoli's certified solderers)



TPL-I-LEAD-3-C
LEAD/END
24" standard 3 conductor
22AWG lead wire factory
attached to one end of tape



TPL-I-LEAD-3-D
LEAD/LEAD
24" standard 3 conductor
22AWG lead wire factory
attached to both ends of tape

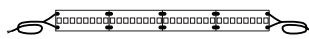

TPL-I-XEP-3
EXTRA LEAD WIRE
Additional factory attached
22AWG lead 3 wire to extend
lengths of LEAD-C and LEAD-D
up to 20 ft. max
Sold per foot

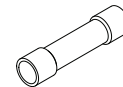

TPL-I-CONN
18-22AWG BUTT CONNECTORS
Used to interconnect factory
attached lead wires.
Sold individually.

Compatible Extrusions

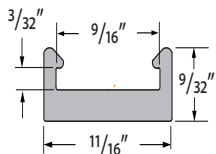

MCHAN-8-LP
Low profile NO LENS OPTION
clear polycarbonate, length 8'

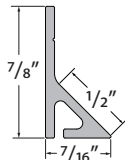

TPL-I-45-MCH-8-S
White PVC, 45° NO LENS
length 8'

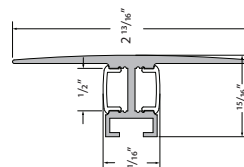

DWAR-CHAN-SLV-6.5
Anodized Aluminum Extrusion,
available in 6.5' lengths

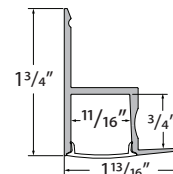

EDGE-CHAN-SLV-6.5
Anodized Aluminum Extrusion,
available in 6.5' lengths

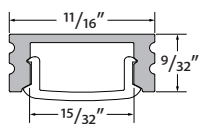

MINI-CHAN-SLV-6.5
Anodized Aluminum Extrusion,
available in 6.5' lengths

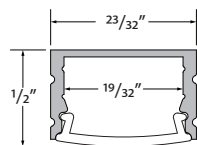

MOFT-CHAN-SLV-6.5
Anodized Aluminum Extrusion,
available in 6.5' lengths

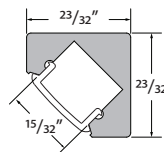

DYER-CHAN-SLV-6.5
Anodized Aluminum Extrusion,
available in 6.5' lengths

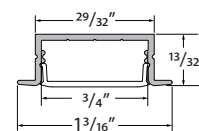

WRNR-CHAN-SLV-6.5
Anodized Aluminum Extrusion,
available in 6.5' lengths

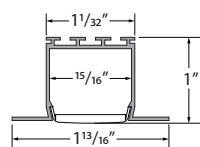

NOYS-CHAN-SLV-6.5
Anodized Aluminum Extrusion,
available in 6.5' lengths

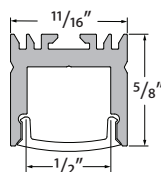

VALN-CHAN-SLV-6.5
Anodized Aluminum Extrusion,
available in 6.5' lengths

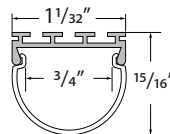

DOME-CHAN-SLV-6.5
Anodized Aluminum Extrusion,
available in 6.5' lengths

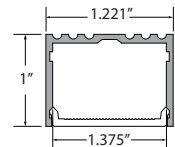

ALTN-CHAN-SLV-6.5
Anodized Aluminum Extrusion,
available in 6.5' lengths

Compatible Extrusions

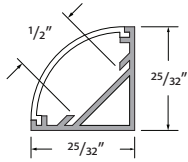

MRS-CHAN-SLV-6.5
Anodized aluminum extrusion available in 6.5' length

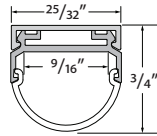

HRIZ-CHAN-SLV-6.5
Anodized aluminum extrusion available in 6.5' length

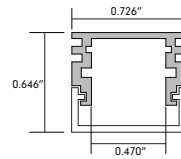

ASTR-CHAN-SLV-6.5
Anodized aluminum extrusion available in 6.5' length

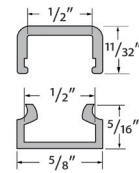

INF-X-CHAN-8
X = **C** (clear), **F** (frosted)
PC extrusion, available in 8' lengths

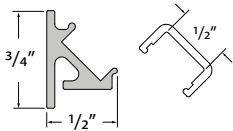

TPL-I-45-MCH-8
White PVC 45° extrusion available in 8' length
INF-X-LNS-8
X = **C** (clear), **F** (frosted)
Polycarbonate lense

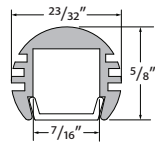

NVOA-CHAN-SLV-6.5
Anodized aluminum extrusion available in 6.5' length

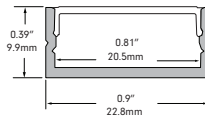

COTA-CHAN-SLV-6.5
Anodized Aluminum Extrusion, available in 6.5' lengths

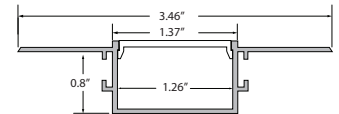

CARU-CHAN-SLV-6.5
Anodized aluminum extrusion, available in 6.5' lengths

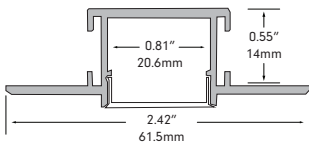

HAYS-CHAN-SLV-6.5
Anodized Aluminum Extrusion, available in 6.5' lengths

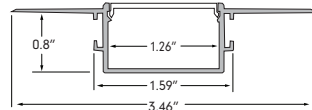

GLOR-CHAN-XXX-6.5
Anodized Aluminum Bendable Extrusion, available in 6.5' lengths

In-Wall Controls



Touchscreen

TVOQ-1-WH
White



Touchscreen

TVOQ-10-XX-7
XX = **BK** (Black), **WH** (White)



Touchscreen

TVOQ-2-BK
Black

Recommended Power Supplies

ADNM - 0-10V DYNAMIC WHITE SINGLE CIRCUIT

DESCRIPTION	CAT NO	APPLICATION	PRIMARY VOLTAGE	SECONDARY VOLTAGE	CIRCUIT BREAKERS	MAX LOAD	CIRCUIT CAPACITY
ADNM Series Class 2 Transformer	ADNM-90-1-4-24-VAOT	INDOOR /	100-277V AC	24V DC	1	90W	3.75A
	ADNM-120-1-4-24-VAOT	OUTDOOR	5ø60 Hz		1	96W	4A

ADNM - 0-10V DYNAMIC WHITE MULTI CIRCUIT

DESCRIPTION	CAT NO	APPLICATION	PRIMARY VOLTAGE	SECONDARY VOLTAGE	CIRCUIT BREAKERS	MAX LOAD	CIRCUIT CAPACITY
ADNM Series Class 2 Transformer	ADNM-240-2-4-24-VAOT	INDOOR /	100-277V AC	24V DC	2	2x96W	2x4A
	ADNM-320-3-4-24-VAOT	OUTDOOR	5ø60 Hz		3	3x96W	3x4A

ADUL/ADNM - DMX SINGLE ADDRESS

DESCRIPTION	CAT NO	APPLICATION	PRIMARY VOLTAGE	SECONDARY VOLTAGE	CIRCUIT BREAKERS	MAX LOAD	CIRCUIT CAPACITY
ADUL/ADNM Series Class 2 Transformer	ADNM-90-1-4-24-DIN	Indoor / Outdoor	100-277V AC 5ø/60 Hz	24V DC	1	90W	3.75A
	ADUL-120-1-4-24-DIN				1	96W	4A
	ADUL-240-2-4-24-DIN				2	2x96W	2x4A
	ADUL-320-3-4-24-DIN				3	3x96W	3x4A

ADUL - DMX MULTI ADDRESS

DESCRIPTION	CAT NO	APPLICATION	PRIMARY VOLTAGE	SECONDARY VOLTAGE	CIRCUIT BREAKERS	MAX LOAD	CIRCUIT CAPACITY
ADUL Series Class 2 Transformer	ADUL-240-2-4-24-DIN-2	Indoor / Outdoor	100-277V AC 5ø/60 Hz	24V DC	2	2x96W	2x4A
	ADUL-320-3-4-24-DIN-3				3	3x96W	3x4A

ADNM - DMX/DALI FLICKER-FREE FOR TV STUDIO

DESCRIPTION	CAT NO	APPLICATION	PRIMARY VOLTAGE	SECONDARY VOLTAGE	CIRCUIT BREAKERS	MAX LOAD	CIRCUIT CAPACITY
ADNM Series Class 2 Transformer	ADNM-120-1-4-24-DTV	Indoor / Outdoor	100-277V AC 50/60 HZ	24V DC	1	1x96W	1x4A
	ADNM-240-2-4-24-DTV				2	2x96W	2x4A
	ADNM-320-3-4-24-DTV				3	3x96W	3x4A

Recommended Dimmers

DIMMING - 0-10V

DESCRIPTION	CAT NO	APPLICATION	INPUT VOLTAGE	OUTPUT VOLTAGE	MAX LOAD	PRICE
0-10V Dimmer	DIM-LD-010	Indoor	12V/24V DC	12V/24V DC	30 mA max. output (sink only)	\$ 120.00/ea